

QHC942-1B, QHC948-1B SPLIT SYSTEM HEAT PUMP

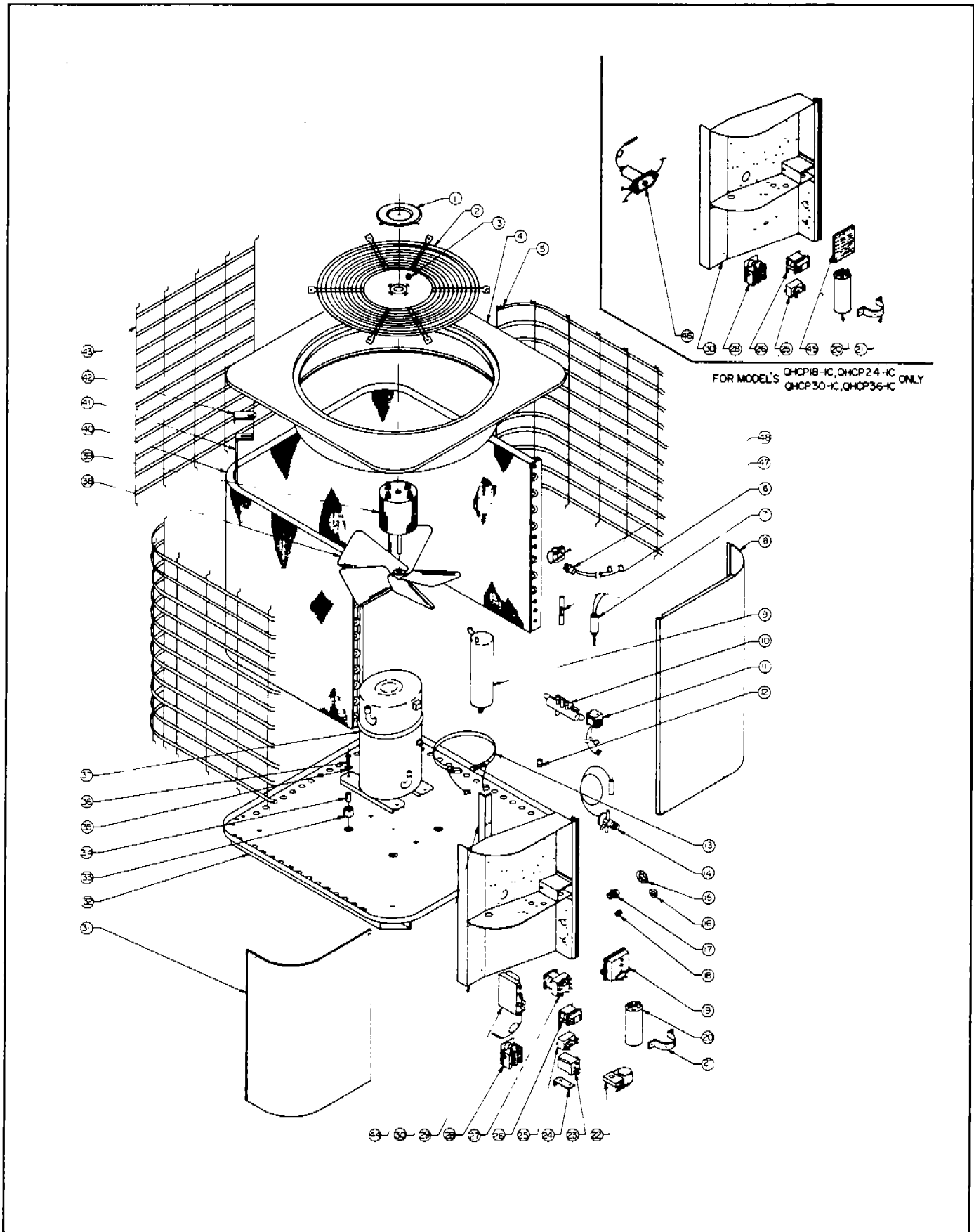

ITEM	DESCRIPTION	42-1B	48-1B
1	CAP-GRILLE	7003-1224	7003-1224
2	GRILLE-DISCHARGE	7051-867	7051-867
3	NUT-HEX, FLANGED (4)	1121-22	1121-22
4	TOP COVER-ASM. WELD	7080-135A	7080-135A
5	GRILLE-INLET, SIDE (2)	7051-908	7051-908
6	VALVE-CHECK	5651-222	5651-222
7	CONTROL-HI PRESSURE	8404-32	8404-32
8	PANEL R.H.	7041-1098A	7041-1098A
9	ACCUMULATOR	5202-43	5202-43
10	VALVE-REVERSING	5651-247	5651-247
11	VALVE-COIL, REV.	8611-601	8611-601
12	DISTRIBUTOR	5651-239	5651-251
13	HEATER-CRANKCASE	7601-194	7601-194
14	VALVE-EXPANSION	5651-246	5651-249
15	FLANGE-MOUNTING, SUCTION	7004-170	7004-170
16	FLANGE-MOUNTING, LIQUID	7004-45	7004-45
17	VALVE-COUPPLING HALF, SUCT.	6093-165	6093-165
18	VALVE-COUPPLING HALF, LIQ.	6093-50	6093-50
19	CONTROL-DEFROST	8404- 38 39	8404- 38 40
20	CAPACITOR-RUN	8552-585	8552-575
21	STRAP-CAPACITOR	7071-52	7071-52
22	THERMOSTAT-HOLDBACK	8403-175	8403-175
23	RELAY-LOCKOUT	8201-185	8201-185
24	BRACKET-RELAY	7003-1334	7003-1334
25	RELAY-COOL	8201-183	8201-183
26	RELAY-DEFROST	8201-117	8201-117
27	RELAY-AUX. DEFROST	8201-186	8201-186
28	CONTACTORS	8401-284	8401-284
29	TIMER-DEFROST	8612-8	8612-8
30	BOX-CONTROL	5360-181A	5360-181A
31	COVER-BOX, CONTROL	7041-1096A	7041-1096A
32	BASE-ASM.	5000-527A	5000-527A
33	GROMMET (4)	5502-57	5502-57
34	SLEEVE (4)	5802-41	5802-41
35	WASHER-FLAT (4)	100075	100075
36	SCREW-CAP (4)	1001-13	1001-13
37	COMPRESSOR	8000-738	8000-666
38	FAN	5151-256	5151-257
39	MOTOR-FAN	8101-574	8101-602
40	CONDENSER	5051-595	5051-606
41	COIL-SUPPORT (2)	7003-1324	7003-1324
42	COIL-BRACKET (2)	7003-1321	7003-1321
43	GRILLE-INLET, FRONT	7051-910	7051-910
44	BRACKET-COIL	7003-1319	7003-1319
45	TIMER-DEFROST, SOLIDSTATE	—	—
46	CONTROL-HI-PRESSURE M.R.	—	—
47	THERMOSTAT-DEFROST	—	—
48	CLIP-THERMOSTAT	—	—